

# INSTALACIÓN DEL DOSIFICADOR DE JABÓN CON SENSOR

Ref. 04061 - 04063

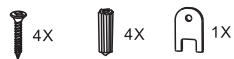
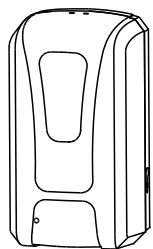

• Medidas (LxWxH): 15.8 x 11.6 x 28.6 cm

• Peso: 950 g.

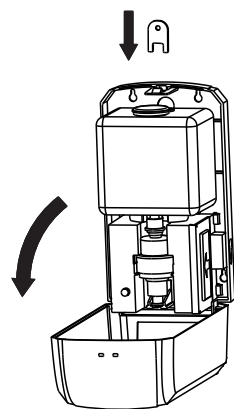

**A**

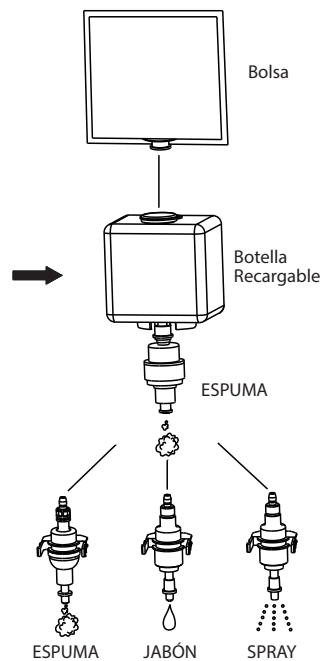

**B**

Altura de instalación recomendada

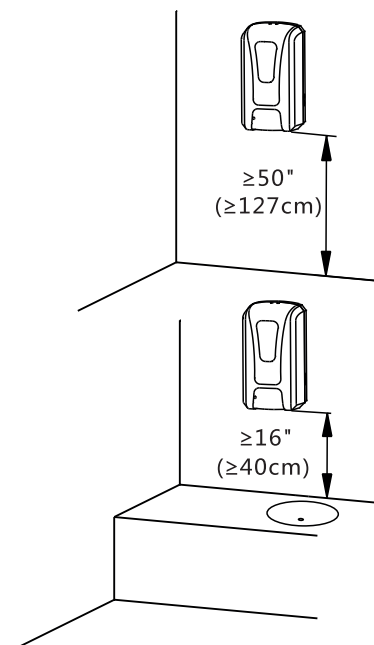

**C**

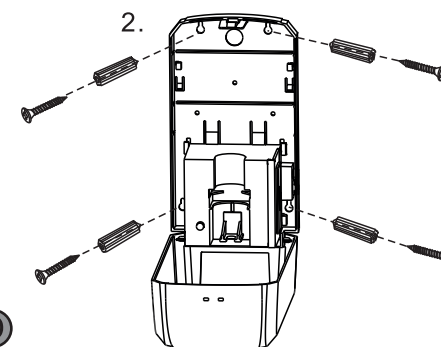
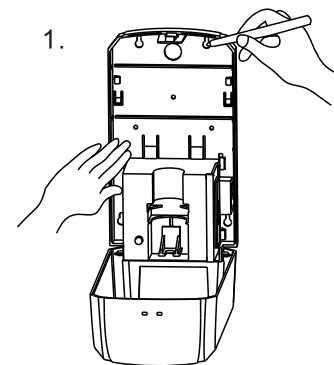

**D**

Instalación de baterías

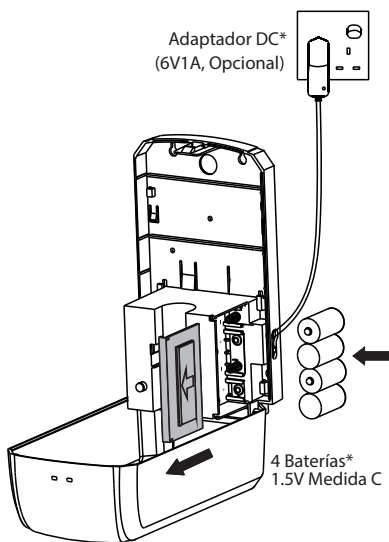

\*El embalaje estándar no incluye el adaptador DC y las baterías

**E**

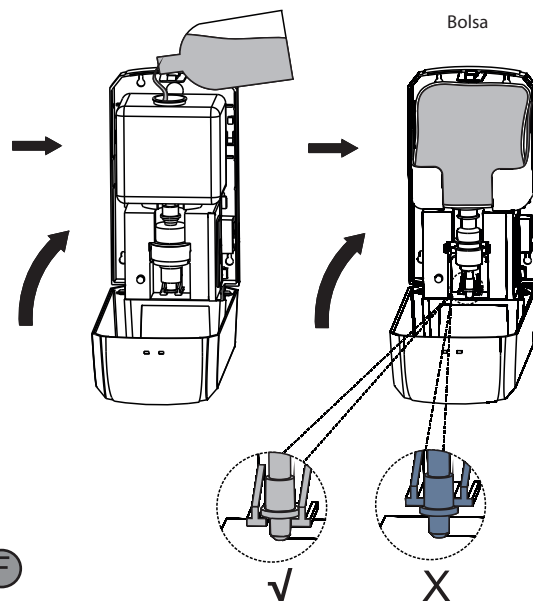

**F**

INSTALACIÓN CON RESPALDO ADHESIVO (sin tornillos)

1. Cinta adhesiva de doble cara\* (Opcional)

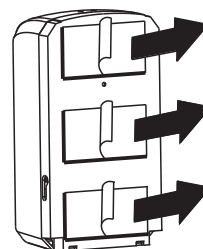

**G**

\*El embalaje estándar no incluye cinta adhesiva de doble cara ni sellador de silicona.

3. Sellador de silicona\*

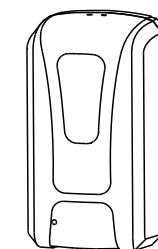
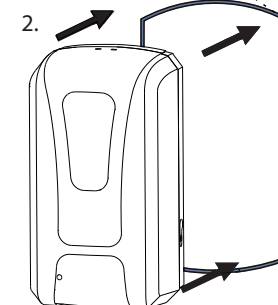

- Desinfección UV
- Doble color LED: Verde, funcionamiento y stand by; Rojo, alarma baja batería
- Distancia de detección: 8-12 cm

**H**

# MANUEL D'INSTALLATION POUR DISTRIBUTEUR À SAVON AUTOMATIQUE

Ref. 04061 - 04063

**simex**  
by climax

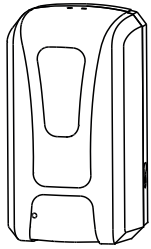

- Taille (L x l x H): 15.8 x 11.6 x 28.6 cm
- Poids: 950 g.

**A**

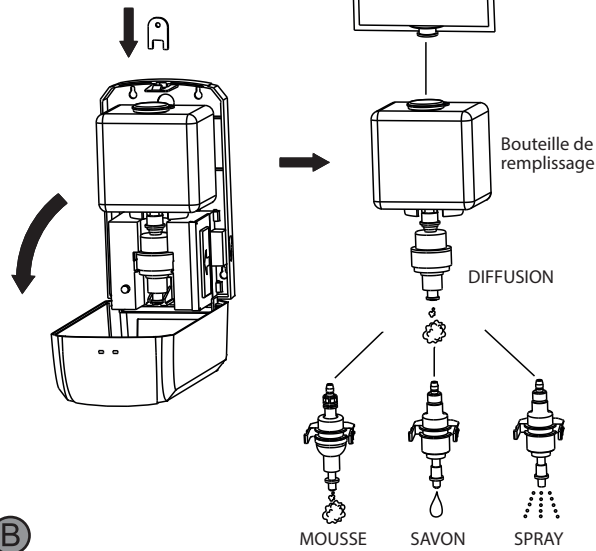

**B**

Hauteur d'installation recommandée

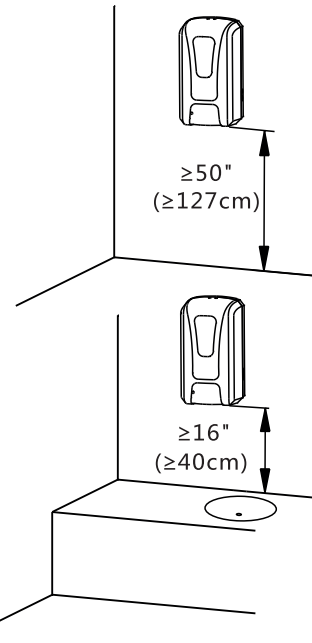

**C**

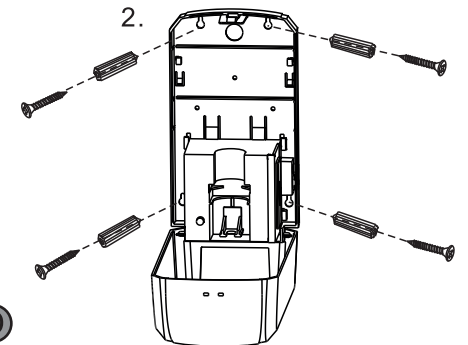
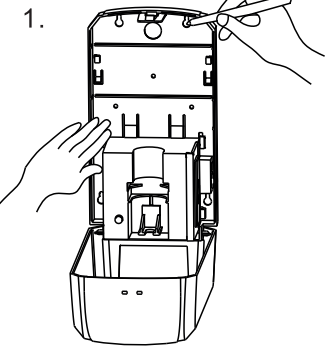

**D**

Installer les piles

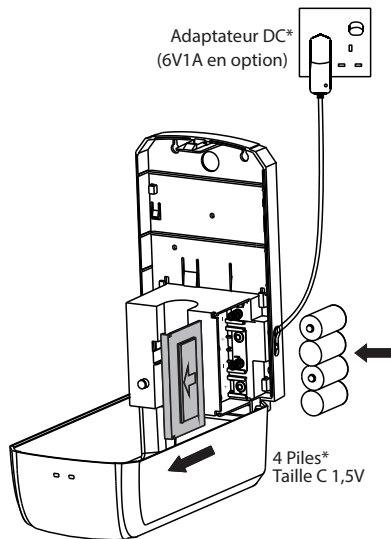

\*Piles et DC adaptateur non fournis

**E**

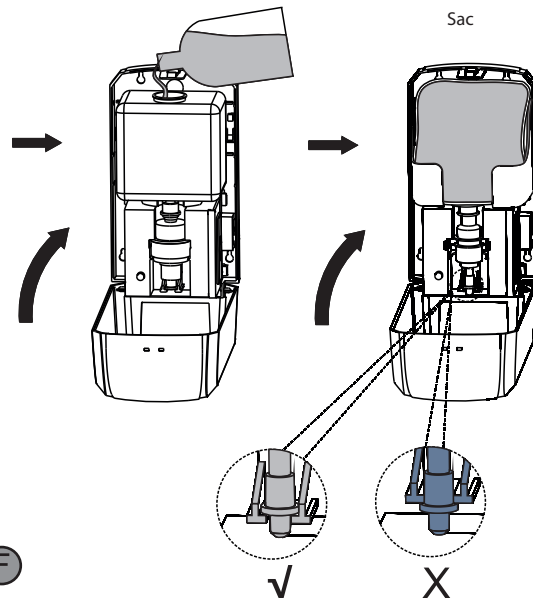

**F**

**Option sans vis:**  
**FIXATION AVEC ADHÉSIVE DOUBLE FACE**

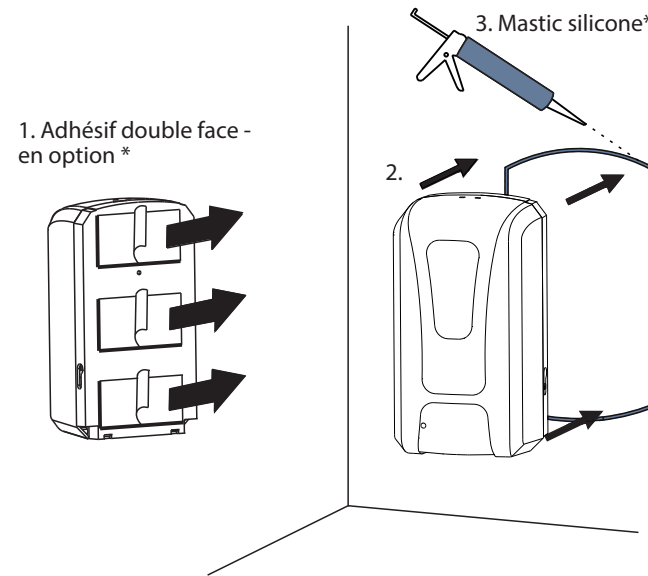

\*Adhésif double face et mastic silicone non inclus

**G**

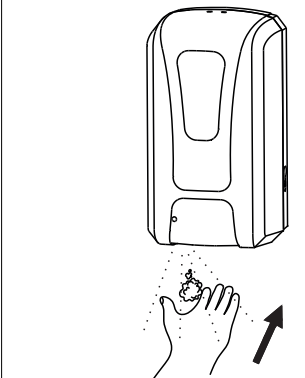

- Capteur infrarouge
- LED 2 couleurs: Vert: appareil en marche ou stand-by  
Rouge: Signal piles faibles
- Distance détection des mains: 8-12 cm

**H**

# SENSOR SOAP DISPENSER INSTALLATION

Ref. 04061 - 04063

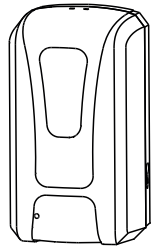

• Size (LxWxH) : 15.8x11.6x28.6cm

• Weight: 950g

**A**

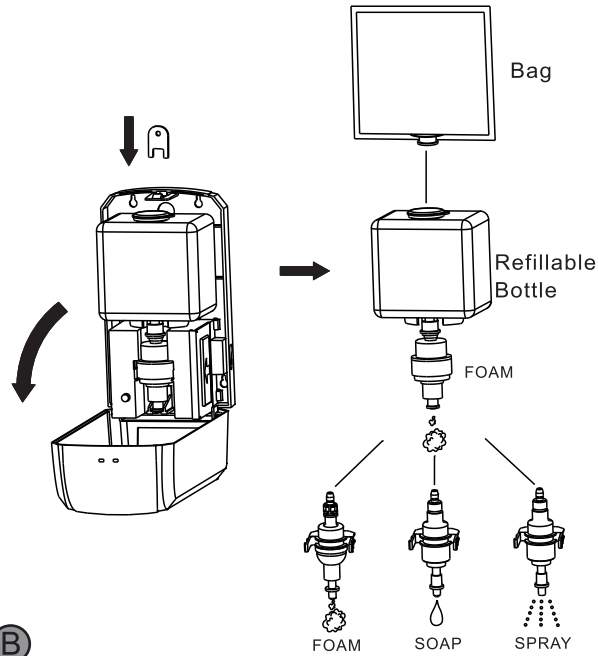

**B**

Recommended Installation Height

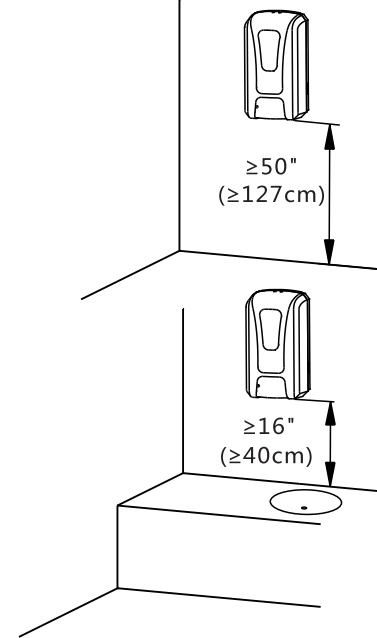

**C**

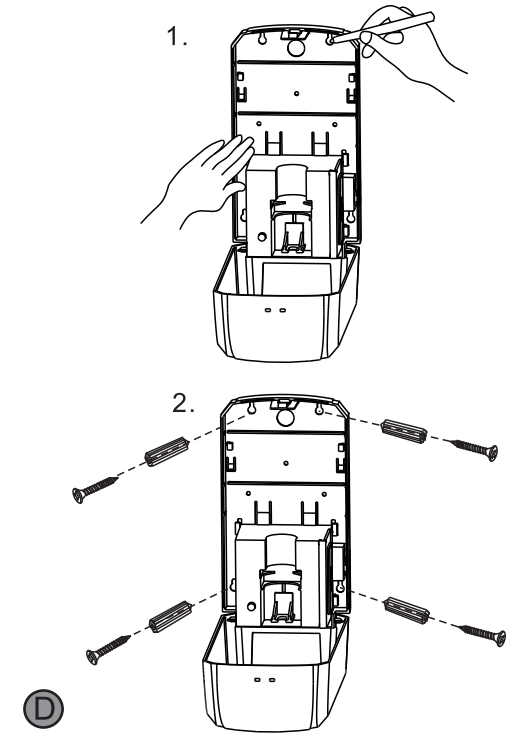

**D**

Install Batteries

DC Adapter ★  
(6V1A, Optional)

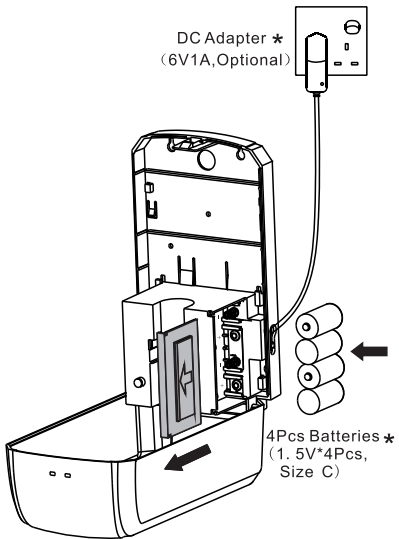

★ The Standard Packing is not including DC Adapter and Batteries

**E**

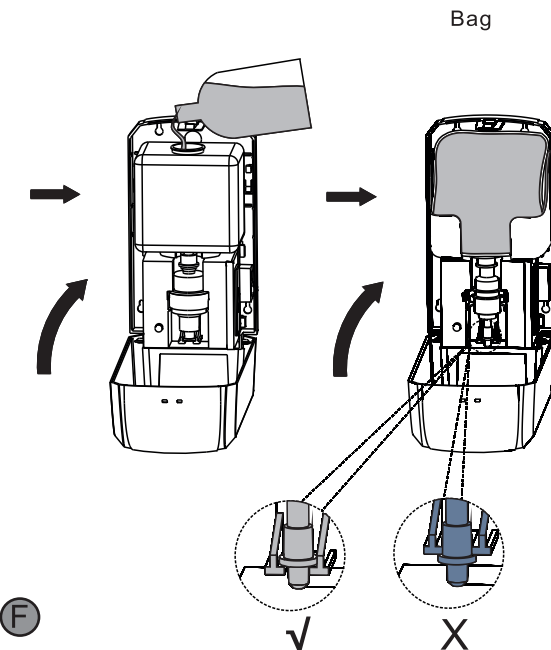

**F**

Installation with Adhesive Backing  
(no screws)

1. Double-sided adhesive★  
(Optional)

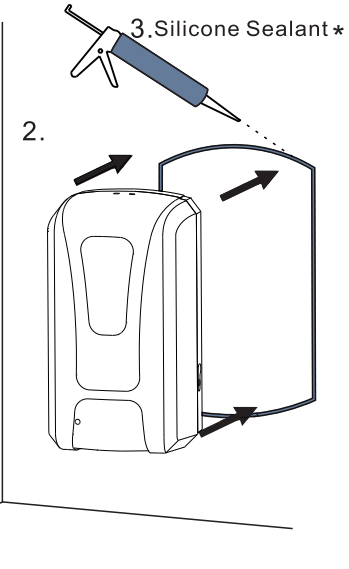
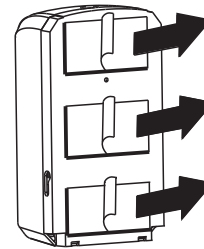

★ The standard Packing is not including Double-sided adhesive and Silicone sealant

**G**

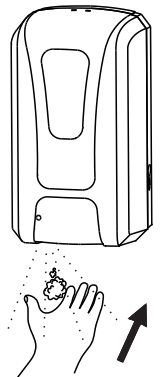

- UV disinfection
- Dual color LED : Green is working and Stand-by;  
Red is Low Battery Alarm.
- Sensing Distance: 8-12cm

**H**

# INSTALACIÓN DE LA BANDEJA

Ref. 04061



Dosificador de jabón

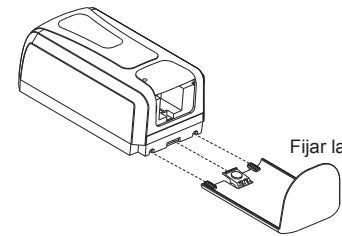

Fijar la bandeja desde este lado

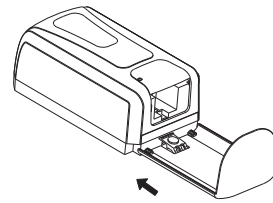

## A Instalación

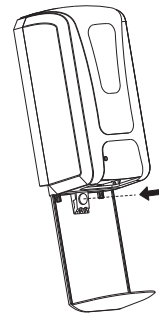

Presione el botón circular para sacar la bandeja

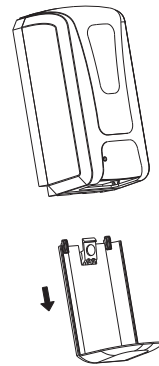

## B Sacar la bandeja

# Instalación para componentes de la base - Ref. 04061

1. Abrir. con llave. Saque la botella y la bomba.

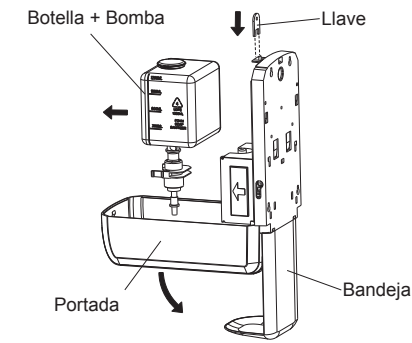

2. Instale el soporte posterior con el dosificador

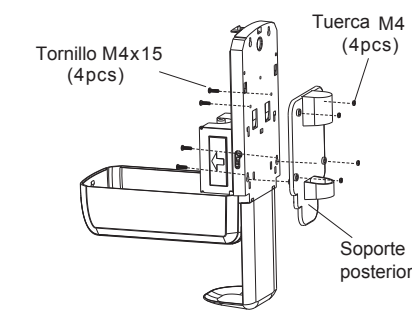

## A Instalar el soporte posterior

1. Ponga la foto publicitaria dentro del tablero AD de 2 piezas

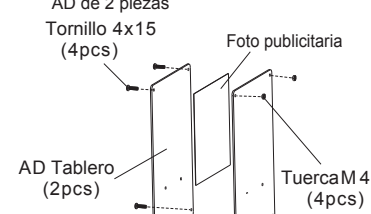

\* Medidas foto publicitaria: 18x 18cm

2. Instalar el tablero AD en el dosificador

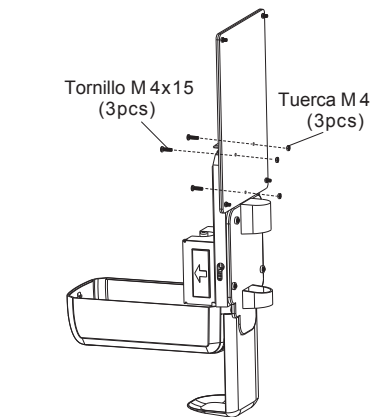

## B Instalar el tablero AD (Si es necesario)

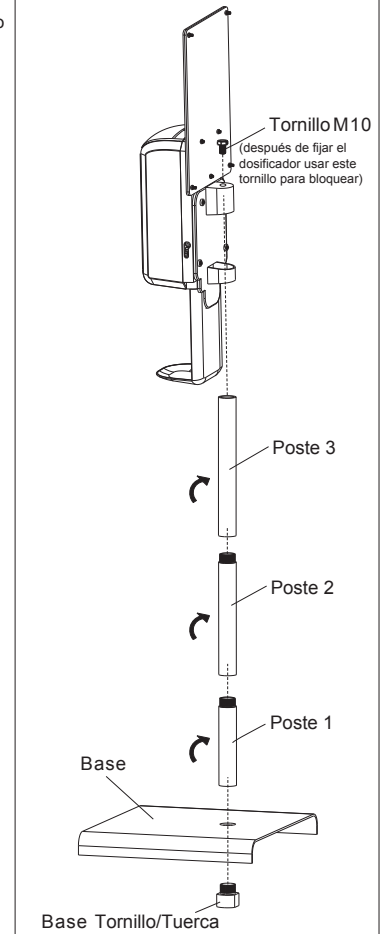

## C Instalar base y poste

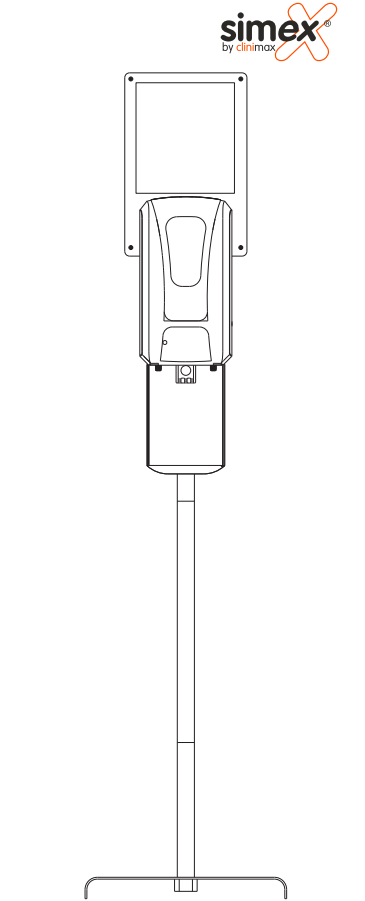

\*Fije 4 baterías de tamaño C y encienda el interruptor. Disfrute de la desinfección de manos.

## D Disfrute de la desinfección de manos